



70 Marlow Road

London, SE20 7UZ

Asking Price £490,000

Presenting a fantastic opportunity to own a Victorian terraced house in the vibrant community of Penge, London. This charming freehold property boasts two double bedrooms, an upstairs bathroom, and generous living spaces, making it an ideal home for families, professionals, or investors.

The property boasts a spacious reception room flooded with natural light, perfect for entertaining or relaxing. The well-appointed kitchen/diner provides ample space for cooking and dining, catering to the needs of contemporary living.

The property benefits from easy access to local amenities, schools, parks, and transportation links. Birkbeck and Anerley stations are within walking distance, providing excellent connectivity to central London and beyond.

Tenure: Freehold
Bromley Council Tax Band C £1816.00

Viewing

Please contact our Galloways Penge Office on 020 8778 1120 if you wish to arrange a viewing appointment for this property or require further information.

- VICTORIAN TERRACED FREEHOLD HOUSE
- TWO DOUBLE BEDROOMS
- CHAIN FREE
- MODERN FITTED KITCHEN/DINER
- 852 SQ FT / 79.2 SQ M TOTAL SQUARE FOOTAGE
- THROUGH RECEPTION ROOM
- 7 MINUTE WALK TO BIRKBECK STATION
- 16 MINUTE WALK TO ANERLEY STATION
- 11 MINUTE WALK TO SOUTH NORWOOD COUNTRY PARK
- (WALKING TIMES ESTIMATED BY GOOGLE MAPS)



2



1



1



D

Floor Plan

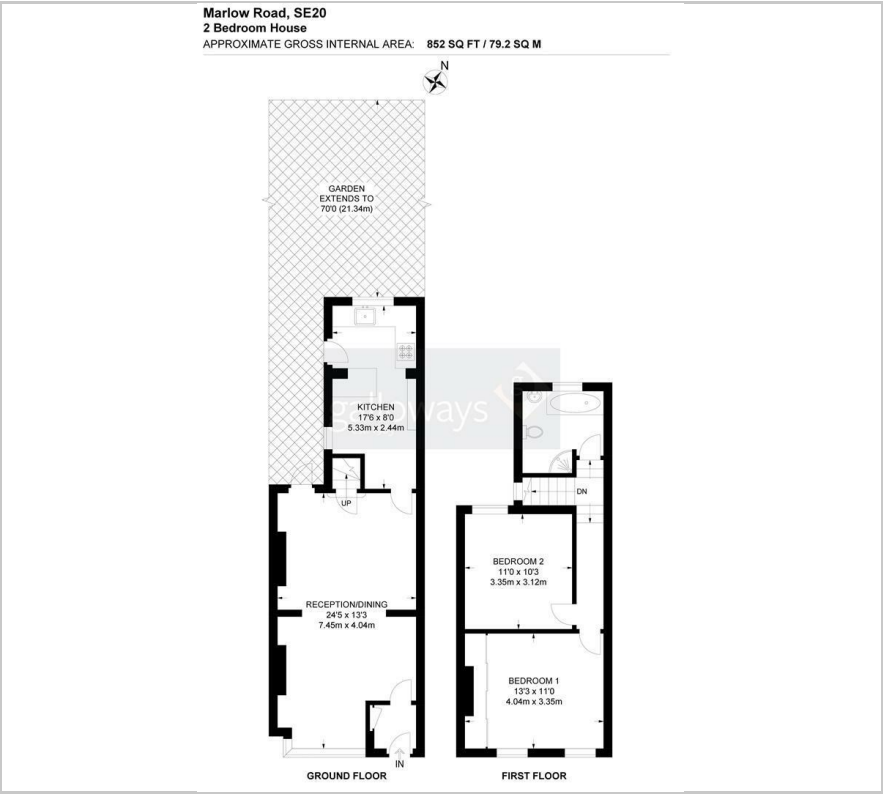

Area Map

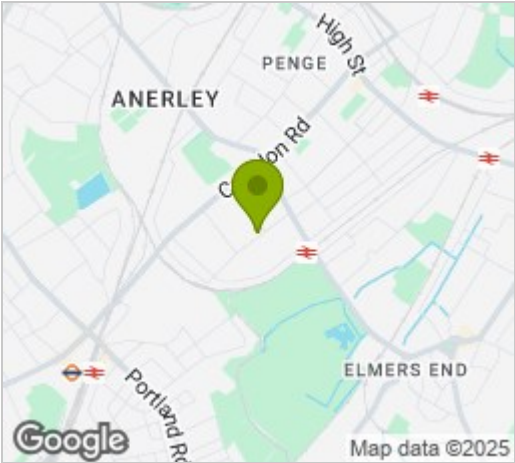

Energy Efficiency Graph

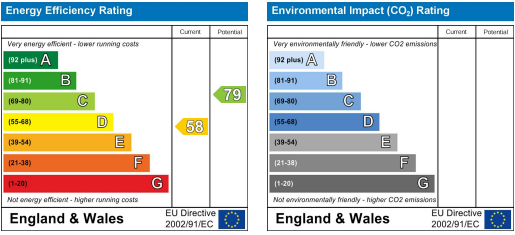

These particulars, whilst believed to be accurate are set out as a general outline only for guidance and do not constitute any part of an offer or contract. Intending purchasers should not rely on them as statements of representation of fact, but must satisfy themselves by inspection or otherwise as to their accuracy. No person in this firms employment has the authority to make or give any representation or warranty in respect of the property.